

## Spur Gear with Hub

|                     |                      |
|---------------------|----------------------|
| Tooth Width "B" for | Tooth Length "A" for |
| Module 1 = 15 mm    | Module 1 = 25 mm     |
| Module 1.5 = 17 mm  | Module 1.5 = 30 mm   |
| Module 2 = 20 mm    | Module 2 = 35 mm     |
| Module 2.5 = 25 mm  | Module 2.5 = 40 mm   |
| Module 3 = 30 mm    | Module 3 = 50 mm     |
| Module 4 = 40 mm    | Module 4 = 60 mm     |
| Module 5 = 50 mm    | Module 5 = 75 mm     |
| Module 6 = 60 mm    | Module 6 = 80 mm     |

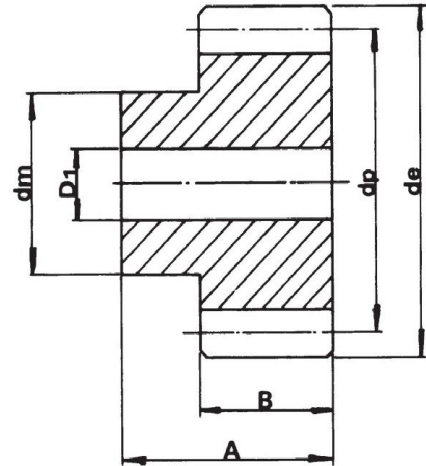

| Z  | Mod.1 |    |    |    | Mod.1.5 |      |    |    | Mod.2 |    |    |    | Mod.2.5 |       |    |    |
|----|-------|----|----|----|---------|------|----|----|-------|----|----|----|---------|-------|----|----|
|    | de    | dp | dm | D1 | de      | dp   | dm | D1 | de    | dp | dm | D1 | de      | dp    | dm | D1 |
| 12 | 14    | 12 | 9  | 6  | 21.0    | 18.0 | 14 | 8  | 28    | 24 | 18 | 10 | 35.0    | 30.0  | 22 | 10 |
| 13 | 15    | 13 | 10 | 6  | 22.5    | 19.5 | 15 | 8  | 30    | 26 | 20 | 10 | 37.5    | 32.5  | 25 | 10 |
| 14 | 16    | 14 | 11 | 6  | 24.0    | 21.0 | 17 | 8  | 32    | 28 | 22 | 10 | 40.0    | 35.0  | 28 | 10 |
| 15 | 17    | 15 | 12 | 6  | 25.5    | 22.5 | 18 | 8  | 34    | 30 | 24 | 10 | 42.5    | 37.5  | 30 | 10 |
| 16 | 18    | 16 | 13 | 6  | 27.0    | 24.0 | 19 | 8  | 36    | 32 | 25 | 10 | 45.0    | 40.0  | 32 | 12 |
| 17 | 19    | 17 | 14 | 6  | 28.5    | 25.5 | 20 | 8  | 38    | 34 | 25 | 10 | 47.5    | 42.5  | 35 | 12 |
| 18 | 20    | 18 | 15 | 8  | 30.0    | 27.0 | 20 | 8  | 40    | 36 | 25 | 10 | 50.0    | 45.0  | 35 | 12 |
| 19 | 21    | 19 | 15 | 8  | 31.5    | 28.5 | 20 | 8  | 42    | 38 | 25 | 10 | 52.5    | 47.5  | 35 | 12 |
| 20 | 22    | 20 | 16 | 8  | 33.0    | 30.0 | 25 | 8  | 44    | 40 | 30 | 10 | 55.0    | 50.0  | 40 | 12 |
| 21 | 23    | 21 | 16 | 8  | 34.5    | 31.5 | 25 | 10 | 46    | 42 | 30 | 12 | 57.5    | 52.5  | 40 | 14 |
| 22 | 24    | 22 | 16 | 8  | 36.0    | 33.0 | 25 | 10 | 48    | 44 | 30 | 12 | 60.0    | 55.0  | 45 | 14 |
| 23 | 25    | 23 | 18 | 8  | 37.5    | 34.5 | 25 | 10 | 50    | 46 | 30 | 12 | 62.5    | 57.5  | 45 | 14 |
| 24 | 26    | 24 | 20 | 10 | 39.0    | 36.0 | 25 | 10 | 52    | 48 | 35 | 12 | 65.0    | 60.0  | 45 | 14 |
| 25 | 27    | 25 | 20 | 10 | 40.5    | 37.5 | 25 | 10 | 54    | 50 | 35 | 12 | 67.5    | 62.5  | 50 | 14 |
| 26 | 28    | 26 | 20 | 10 | 42.0    | 39.0 | 30 | 12 | 56    | 52 | 40 | 12 | 70.0    | 65.0  | 50 | 14 |
| 27 | 29    | 27 | 20 | 10 | 43.5    | 40.5 | 30 | 12 | 58    | 54 | 40 | 12 | 72.5    | 67.5  | 50 | 14 |
| 28 | 30    | 28 | 20 | 10 | 45.0    | 42.0 | 30 | 12 | 60    | 56 | 40 | 12 | 75.0    | 70.0  | 50 | 14 |
| 29 | 31    | 29 | 20 | 10 | 46.5    | 43.5 | 30 | 12 | 62    | 58 | 40 | 14 | 77.5    | 72.5  | 50 | 14 |
| 30 | 32    | 30 | 20 | 10 | 48.0    | 45.0 | 30 | 12 | 64    | 60 | 40 | 14 | 80.0    | 75.0  | 55 | 14 |
| 31 | 33    | 31 | 25 | 10 | 49.5    | 46.5 | 35 | 12 | 66    | 62 | 45 | 14 | 82.5    | 77.5  | 55 | 16 |
| 32 | 34    | 32 | 25 | 10 | 51.0    | 48.0 | 35 | 12 | 68    | 64 | 45 | 14 | 85.0    | 80.0  | 55 | 16 |
| 33 | 35    | 33 | 25 | 10 | 52.5    | 49.5 | 35 | 12 | 70    | 66 | 45 | 14 | 87.5    | 82.5  | 55 | 16 |
| 34 | 36    | 34 | 25 | 10 | 54.0    | 51.0 | 35 | 12 | 72    | 68 | 45 | 14 | 90.0    | 85.0  | 55 | 16 |
| 35 | 37    | 35 | 25 | 10 | 55.5    | 52.5 | 35 | 12 | 74    | 70 | 45 | 14 | 92.5    | 87.5  | 60 | 16 |
| 36 | 38    | 36 | 25 | 10 | 57.0    | 54.0 | 35 | 12 | 76    | 72 | 45 | 14 | 95.0    | 90.0  | 60 | 16 |
| 37 | 39    | 37 | 25 | 10 | 58.5    | 55.5 | 40 | 12 | 78    | 74 | 50 | 14 | 97.5    | 92.5  | 60 | 16 |
| 38 | 40    | 38 | 25 | 10 | 60.0    | 57.0 | 40 | 12 | 80    | 76 | 50 | 14 | 100.0   | 95.0  | 60 | 16 |
| 39 | 41    | 39 | 25 | 10 | 61.5    | 58.5 | 40 | 12 | 82    | 78 | 50 | 14 | 102.5   | 97.5  | 60 | 16 |
| 40 | 42    | 40 | 25 | 10 | 63.0    | 60.0 | 40 | 12 | 84    | 80 | 50 | 14 | 105.0   | 100.0 | 70 | 16 |
| 41 | 43    | 41 | 30 | 10 | 64.5    | 61.5 | 40 | 12 | 86    | 82 | 55 | 16 | 107.5   | 102.5 | 70 | 16 |
| 42 | 44    | 42 | 30 | 10 | 66.0    | 63.0 | 50 | 12 | 88    | 84 | 55 | 16 | 110.0   | 105.0 | 70 | 16 |
| 43 | 45    | 43 | 30 | 10 | 67.5    | 64.5 | 50 | 12 | 90    | 86 | 55 | 16 | 112.5   | 107.5 | 70 | 16 |
| 44 | 46    | 44 | 30 | 10 | 69.0    | 66.0 | 50 | 12 | 92    | 88 | 60 | 16 | 115.0   | 110.0 | 70 | 16 |



# SICHUAN MIGHTY MACHINERY CO.,LTD.

Exceptional quality comes from Professional Technology.

| Z  | Mod.1 |    |    |    | Mod.1.5 |       |    |    | Mod.2 |     |    |    | Mod.2.5 |       |     |    |
|----|-------|----|----|----|---------|-------|----|----|-------|-----|----|----|---------|-------|-----|----|
|    | de    | dp | dm | D1 | de      | dp    | dm | D1 | de    | dp  | dm | D1 | de      | dp    | dm  | D1 |
| 45 | 47    | 45 | 30 | 10 | 70.5    | 67.5  | 50 | 12 | 94    | 90  | 60 | 16 | 117.5   | 112.5 | 70  | 16 |
| 46 | 48    | 46 | 30 | 10 | 72.0    | 69.0  | 50 | 14 | 96    | 92  | 60 | 16 | 120.0   | 115.0 | 70  | 20 |
| 47 | 49    | 47 | 30 | 10 | 73.5    | 70.5  | 50 | 14 | 98    | 94  | 70 | 16 | 122.5   | 117.5 | 80  | 20 |
| 48 | 50    | 48 | 30 | 10 | 75.0    | 72.0  | 50 | 14 | 100   | 96  | 70 | 16 | 125.0   | 120.0 | 80  | 20 |
| 49 | 51    | 49 | 30 | 10 | 76.5    | 73.5  | 50 | 14 | 102   | 98  | 70 | 16 | 127.5   | 122.5 | 80  | 20 |
| 50 | 52    | 50 | 30 | 12 | 78.0    | 75.0  | 50 | 14 | 104   | 100 | 70 | 16 | 130.0   | 125.0 | 80  | 20 |
| 51 | 53    | 51 | 40 | 12 | 79.5    | 76.5  | 60 | 14 | 106   | 102 | 70 | 16 | 132.5   | 127.5 | 80  | 20 |
| 52 | 54    | 52 | 40 | 12 | 81.0    | 78.0  | 60 | 14 | 108   | 104 | 70 | 16 | 135.0   | 130.0 | 90  | 20 |
| 53 | 55    | 53 | 40 | 12 | 82.5    | 79.5  | 60 | 14 | 110   | 106 | 70 | 16 | 137.5   | 132.5 | 90  | 20 |
| 54 | 56    | 54 | 40 | 12 | 84.0    | 81.0  | 60 | 14 | 112   | 108 | 70 | 16 | 140.0   | 135.0 | 90  | 20 |
| 55 | 57    | 55 | 40 | 12 | 85.5    | 82.5  | 60 | 14 | 114   | 110 | 70 | 16 | 142.5   | 137.5 | 90  | 20 |
| 56 | 58    | 56 | 40 | 12 | 87.0    | 84.0  | 60 | 16 | 116   | 112 | 70 | 16 | 145.0   | 140.0 | 100 | 20 |
| 57 | 59    | 57 | 40 | 12 | 88.5    | 85.5  | 60 | 16 | 118   | 114 | 70 | 16 | 147.5   | 142.5 | 100 | 20 |
| 58 | 60    | 58 | 40 | 12 | 90.0    | 87.0  | 60 | 16 | 120   | 116 | 70 | 16 | 150.0   | 145.0 | 100 | 20 |
| 59 | 61    | 59 | 40 | 12 | 91.5    | 88.5  | 60 | 16 | 122   | 118 | 70 | 16 | 152.5   | 147.5 | 100 | 20 |
| 60 | 62    | 60 | 40 | 12 | 93.0    | 90.0  | 60 | 16 | 124   | 120 | 70 | 16 |         |       |     |    |
| 61 | 63    | 61 | 50 | 12 | 94.5    | 91.5  | 70 | 16 | 126   | 122 | 80 | 16 | 155.0   | 150.0 | 100 | 20 |
| 62 | 64    | 62 | 50 | 12 | 96.0    | 93.0  | 70 | 16 | 128   | 124 | 80 | 16 |         |       |     |    |
| 63 | 65    | 63 | 50 | 12 | 97.5    | 94.5  | 70 | 16 | 130   | 126 | 80 | 16 |         |       |     |    |
| 64 | 66    | 64 | 50 | 12 | 99.0    | 96.0  | 70 | 16 | 132   | 128 | 80 | 16 | 167.5   | 162.5 |     | 20 |
| 65 | 67    | 65 | 50 | 12 | 100.5   | 97.5  | 70 | 16 | 134   | 130 | 80 | 16 |         |       |     |    |
| 66 | 68    | 66 | 50 | 12 | 102.0   | 99.0  | 70 | 16 | 136   | 132 | 80 | 16 |         |       |     |    |
| 67 | 69    | 67 | 50 | 12 | 103.5   | 100.5 | 70 | 16 | 138   | 134 | 80 | 16 |         |       |     |    |
| 68 | 70    | 68 | 50 | 12 | 105.0   | 102.0 | 70 | 16 | 140   | 136 | 80 | 16 |         |       |     |    |
| 69 | 71    | 69 |    | 12 | 106.5   | 103.5 |    | 16 | 142   | 138 |    | 16 |         |       |     |    |
| 70 | 72    | 70 | 50 | 12 | 108.0   | 105.0 | 70 | 16 | 144   | 140 | 80 | 16 | 180.0   | 175.0 |     | 20 |
| 72 | 74    | 72 | 50 | 12 | 111.0   | 108.0 | 70 | 16 | 148   | 144 | 80 | 16 | 185.0   | 180.0 |     | 20 |
| 75 | 77    | 75 |    | 12 | 115.5   | 112.5 |    | 16 | 154   | 150 |    | 20 | 192.5   | 187.5 |     | 20 |
| 76 | 78    | 76 |    | 12 | 117.0   | 114.0 |    | 16 | 156   | 152 |    | 20 | 195.0   | 190.0 |     | 20 |
| 80 | 82    | 80 |    | 12 | 123.0   | 120.0 |    | 16 | 164   | 160 |    | 20 | 205.0   | 200.0 |     | 25 |
| 85 | 87    | 85 |    | 12 | 130.5   | 127.5 |    | 16 | 174   | 170 |    | 20 | 217.5   | 212.5 |     | 25 |
| 90 | 92    | 90 |    | 12 | 138.0   | 135.0 |    | 16 | 184   | 180 |    | 20 | 230.0   | 225.0 |     | 25 |



# SICHUAN MIGHTY MACHINERY CO.,LTD.

Exceptional quality comes from Professional Technology.

| Z  | Mod.3 |     |     |    | Mod.4 |       |    |    | Mod.5 |       |     |    | Mod.6 |       |     |    |
|----|-------|-----|-----|----|-------|-------|----|----|-------|-------|-----|----|-------|-------|-----|----|
|    | de    | dp  | dm  | D1 | de    | dp    | dm | D1 | de    | dp    | dm  | D1 | de    | dp    | dm  | D1 |
| 12 | 42    | 36  | 27  | 12 | 56.0  | 48.0  | 35 | 14 | 70.0  | 60.0  | 45  | 20 |       |       |     |    |
| 13 | 45    | 39  | 30  | 12 | 60.0  | 52.0  | 40 | 14 | 75.0  | 65.0  | 50  | 20 | 84.0  | 72.0  | 54  | 20 |
| 14 | 48    | 42  | 33  | 12 | 64.0  | 56.0  | 45 | 14 | 80.0  | 70.0  | 55  | 20 | 90.0  | 78.0  | 60  | 20 |
| 15 | 51    | 45  | 35  | 12 | 68.0  | 60.0  | 45 | 14 | 85.0  | 75.0  | 60  | 20 |       |       |     |    |
| 16 | 54    | 48  | 38  | 14 | 72.0  | 64.0  | 50 | 16 | 90.0  | 80.0  | 65  | 20 | 102.0 | 90.0  | 70  | 20 |
| 17 | 57    | 51  | 42  | 14 | 76.0  | 68.0  | 50 | 16 | 95.0  | 85.0  | 70  | 20 | 108.0 | 96.0  | 75  | 20 |
| 18 | 60    | 54  | 45  | 14 | 80.0  | 72.0  | 50 | 16 | 100.0 | 90.0  | 70  | 20 |       |       |     |    |
| 19 | 63    | 57  | 45  | 14 | 84.0  | 76.0  | 60 | 16 | 105.0 | 95.0  | 70  | 20 | 120.0 | 108.0 | 80  | 20 |
| 20 | 66    | 60  | 45  | 14 | 88.0  | 80.0  | 60 | 16 | 110.0 | 100.0 | 80  | 20 | 132.0 | 120.0 | 90  | 20 |
| 21 | 69    | 63  | 45  | 16 | 92.0  | 84.0  | 70 | 16 | 115.0 | 105.0 | 80  | 20 |       |       |     |    |
| 22 | 72    | 66  | 50  | 16 | 96.0  | 88.0  | 70 | 16 | 120.0 | 110.0 | 80  | 20 |       |       |     |    |
| 23 | 75    | 69  | 50  | 16 | 100.0 | 92.0  | 75 | 20 | 125.0 | 115.0 | 90  | 20 |       |       |     |    |
| 24 | 78    | 72  | 50  | 16 | 104.0 | 96.0  | 75 | 20 | 130.0 | 120.0 | 90  | 20 | 156.0 | 144.0 | 110 | 25 |
| 25 | 81    | 75  | 60  | 16 | 108.0 | 100.0 | 75 | 20 | 135.0 | 125.0 | 90  | 20 | 162.0 | 150.0 | 110 | 25 |
| 26 | 84    | 78  | 60  | 16 | 112.0 | 104.0 | 75 | 20 | 140.0 | 130.0 | 100 | 20 |       |       |     |    |
| 27 | 87    | 81  | 60  | 16 | 116.0 | 108.0 | 75 | 20 | 145.0 | 135.0 | 100 | 20 |       |       |     |    |
| 28 | 90    | 84  | 60  | 16 | 120.0 | 112.0 | 75 | 20 | 150.0 | 140.0 | 100 | 25 | 180.0 | 168.0 |     | 25 |
| 29 | 93    | 87  | 60  | 16 | 124.0 | 116.0 | 75 | 20 | 155.0 | 145.0 | 110 | 25 |       |       |     |    |
| 30 | 96    | 90  | 60  | 16 | 128.0 | 120.0 | 75 | 20 | 160.0 | 150.0 | 110 | 25 | 192.0 | 180.0 |     | 25 |
| 31 | 99    | 93  | 60  | 16 | 132.0 | 124.0 | 80 | 20 | 170.0 | 160.0 | 110 | 25 | 204.0 | 192.0 |     | 25 |
| 32 | 102   | 96  | 70  | 16 | 136.0 | 128.0 | 80 | 20 |       |       |     |    |       |       |     |    |
| 33 | 105   | 99  | 70  | 16 | 140.0 | 132.0 | 80 | 20 |       |       |     |    |       |       |     |    |
| 34 | 108   | 102 | 70  | 16 | 144.0 | 136.0 | 80 | 20 | 185.0 | 175.0 |     | 25 | 222.0 | 210.0 |     | 25 |
| 35 | 111   | 105 | 70  | 16 | 148.0 | 140.0 | 80 | 20 |       |       |     |    |       |       |     |    |
| 36 | 114   | 108 | 70  | 20 | 152.0 | 144.0 |    | 25 |       |       |     |    |       |       |     |    |
| 37 | 117   | 111 | 70  | 20 | 160.0 | 152.0 | 80 | 25 | 200.0 | 190.0 |     | 25 | 240.0 | 220.0 |     | 25 |
| 38 | 120   | 114 | 80  | 20 |       |       |    |    |       |       |     |    |       |       |     |    |
| 39 | 123   | 117 | 80  | 20 |       |       |    |    |       |       |     |    |       |       |     |    |
| 40 | 126   | 120 | 80  | 20 | 168.0 | 160.0 |    | 25 | 210.0 | 200.0 |     | 25 | 252.0 | 240.0 |     | 25 |
| 41 | 129   | 138 | 90  | 20 |       |       |    |    |       |       |     |    |       |       |     |    |
| 42 | 132   | 126 | 80  | 20 |       |       |    |    |       |       |     |    |       |       |     |    |
| 43 | 135   | 129 | 80  | 20 |       |       |    |    |       |       |     |    |       |       |     |    |
| 44 | 138   | 132 | 90  | 20 |       |       |    |    |       |       |     |    |       |       |     |    |
| 45 | 141   | 135 | 90  | 20 |       |       |    |    |       |       |     |    |       |       |     |    |
| 46 | 144   | 138 | 90  | 20 | 188.0 | 180.0 |    | 25 | 235.0 | 225.0 |     | 25 |       |       |     |    |
| 47 | 147   | 141 | 100 | 20 |       |       |    |    |       |       |     |    |       |       |     |    |
| 48 | 150   | 144 |     | 20 | 200.0 | 192.0 |    | 25 | 250.0 | 240.0 |     | 25 |       |       |     |    |
| 50 | 156   | 150 | 100 | 20 | 208.0 | 200.0 |    | 25 | 260.0 | 250.0 |     | 30 |       |       |     |    |
| 52 | 162   | 156 |     | 20 | 216.0 | 208.0 |    | 25 | 270.0 | 260.0 |     | 30 |       |       |     |    |
| 55 | 171   | 165 |     | 20 | 228.0 | 220.0 |    | 25 | 285.0 | 275.0 |     | 30 |       |       |     |    |
| 57 | 177   | 171 |     | 20 | 236.0 | 228.0 |    | 25 | 295.0 | 285.0 |     | 30 |       |       |     |    |
| 60 | 186   | 180 |     | 20 | 248.0 | 240.0 |    | 25 | 310.0 | 300.0 |     | 30 |       |       |     |    |
| 65 | 201   | 195 |     | 20 | 268.0 | 260.0 |    | 25 | 335.0 | 325.0 |     | 30 |       |       |     |    |
| 70 | 216   | 210 |     | 25 | 288.0 | 280.0 |    | 25 | 360.0 | 350.0 |     | 30 |       |       |     |    |
| 72 | 222   | 216 |     | 25 |       |       |    |    |       |       |     |    |       |       |     |    |
| 75 | 231   | 225 |     | 25 | 308.0 | 300.0 |    | 25 | 385.0 | 375.0 |     | 30 |       |       |     |    |
| 76 | 234   | 228 |     | 25 | 312.0 | 304.0 |    | 30 | 390.0 | 380.0 |     | 30 |       |       |     |    |
| 80 | 246   | 240 |     | 25 | 328.0 | 320.0 |    | 30 | 410.0 | 400.0 |     | 30 |       |       |     |    |
| 85 | 261   | 255 |     | 25 | 348.0 | 340.0 |    | 30 | 435.0 | 425.0 |     | 30 |       |       |     |    |
| 90 | 276   | 270 |     | 25 | 368.0 | 360.0 |    | 30 | 460.0 | 450.0 |     | 30 |       |       |     |    |
| 95 | 291   | 285 |     | 25 | 388.0 | 380.0 |    | 30 | 485.0 | 475.0 |     | 30 |       |       |     |    |